



Welcome to the Autumn 2018 edition of the SCIP Newsletter.

Late in 2017 we sent surveys to our Southland and Otago patients on the development of regional services. We provide visiting services in many other areas but we have not offered this in Southland and Otago to date. The results of the survey are still being collated but we expect to have these ready for communication soon. Amongst other things the survey asked people to consider what they need from a regional service in future.

In the meantime, we have already completed our first visiting clinic to the Southland region. This was carried out at Southland Hospital with the help of the local DHB Audiology department on 7-9 March. Some photographs of patients seen in the visiting clinic are reproduced here. We hope to offer a visiting service to the Otago region soon.

We are bursting at the seams in our Christchurch rooms as patient numbers grow. In the very near future we will be expanding in to an adjoining clinic space (the old Southern Community Labs clinic). This will give us 50% more floor area than we have at the moment. We expect to have any renovations completed by the Spring and will keep people updated as things progress.

This edition we have a story from Phillip Milne. Phillip recently competed as a member of the New Zealand team at the physical disability rugby league (PDRL) Commonwealth Championships in Australia where the team won silver. Thanks Phillip for your story; if you have something to share then please let us know—we would love to publish your story here.

The results of the 2017 Loud Shirt Day fundraiser have been collated and this year the SCIP benefited to the tune of just over \$27,618. Thank you to all those who gave generously. In keeping with the intentions of Loud Shirt Day, funds will be applied to Habilitation services in the paediatric programme.

The programme is now offering the Oticon Medical cochlear implant system. This means we now offer and support all the major implant brands. The Oticon Medical system, like the MED-EL and Advanced Bionics system, is currently only available to privately funded patients.

Enjoy the Newsletter.

Neil Heslop, General Manager

Inside this issue...

- 2 *Staff News*
- 3 *MC Refurbishment*
- 4 *Southland Clinic*
- 6 *Patient Story—
Phillip Milne*
- 8 *LSD Update*
- 9 *Oticon Medical*
- 10 *Connectivity update*
- 11 *CI User Group info*
- 12 *Facebook/Website*
- 13 *Troubleshooting*
- 14 *Bits 'n pieces*
- 16 *Staff contact info*
- 17 *Clinic info*

Publication Dates:

The SCIP Newsletter is published 3 times per year approximately the end of March, July, and November.

The Newsletter will be distributed by email to patients who we hold an email address for. If the address we have on file is not correct or we have no email address on file we will send the Newsletter by standard mail. The Newsletter is also distributed to the relevant professional groups in our region.

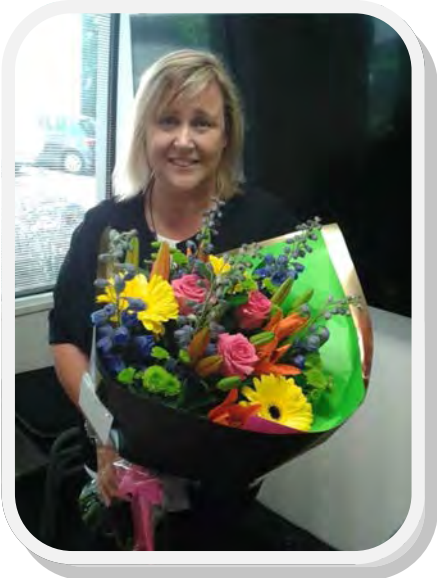

Joanne with her congratulatory flowers

All of Joanne's hard work has paid off!

In the past few years SCIP Habilitationist Joanne Lake has been studying toward her LSLS Cert AVT qualification.

In November 2017 she completed the final examination and we are pleased to announce she passed with flying colours!

She can now officially have bestowed upon her the title "Auditory Verbal Therapist".

Well done Joanne!

Penny attends 9th Adult Aural Rehab conference in Florida

"I was lucky enough to be able to attend this conference which was held at St Pete Beach in Florida back in December 2017.

I have attended two other Geoff Plant conferences over the years and have always found them to be very informative and a great way to network with others from around the globe.

The conference this year was focused on the importance of Aural Rehabilitation and how best to implement this. There was a general feeling that there needed to be more emphasis placed on the after care rather than just straight out Audiology, be that with hearing aids or cochlear implants. It was felt that over the years, there had been a move away from this and that that imbalance needed to be corrected. The issue of having time to do so was a major stumbling block. A lot of the conference was focused on how to deliver these services in a smarter way.

There was much discussion around Telehealth as a way of providing services, remote mapping and remote Rehabilitation programs. There was much discussion around this and obvious advantages and disadvantages. There were interesting presentations around family focused rehab and the importance of this".

From Penny Monteath, CI Rehabilitationist.



Penny with Nancy Tye-Murray in sunny Florida



Milford Chambers refurbishment and expansion.

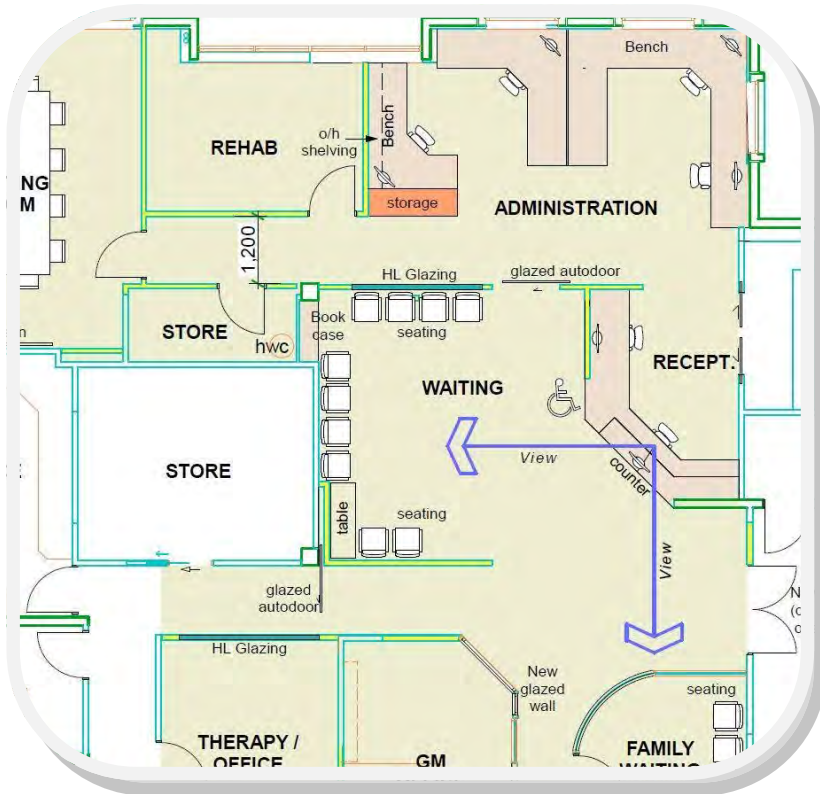

It's time for a makeover ... with increasing staff and patient numbers there's a need for more space at our Christchurch clinic. The rooms immediately adjacent have become free and we've an option to take up that space in addition to the space we already have. It'll add about 110 square meters, 50% more than we have at the moment.

Planning is underway and once we start there might be a little bit of disruption. We'll endeavour to keep you up to date, likely via Facebook, as information comes to hand.

Hearing Dogs



Have you ever thought about getting a hearing dog? Hearing dogs are trained to alert you to sounds in your environment—they can help increase your feelings of security and independence. Find out more at www.hearingdogs.org.nz



First visiting clinic for Southland

Shirley, SCIP Audiologist, and Megan Chinnery, SCIP Habilitationist, were in Invercargill during the first week of March to see both child and adult patients for MAPping and Habilitation. They were kept very busy seeing a total of 5 children and 3 adults for MAPping at the Southland Hospital Audiology Department and Megan also squeezed in some home Habilitation visits too! The patients seen were very excited to have the SCIP come to them for the first time ever. Future visits to Southland will likely be scheduled based on the excellent feedback from both staff and patients this time around.



Clockwise from top left:

Alyssia Johnston-Weir, Indy Conway, Emmelia Turner, Grace Matthews and Masyn Johnston-Weir all did a wonderful job MAPping with Shirley and Megan.





Talk to your SCIP audiologist if you are interested in future visiting clinics, both in Southland or in our other regions.

Rex Pahl and Suzanne Miller at their MAPping session with Shirley at Southland Hospital.



Eco-friendly email option available for appointment letters

Appointment letters are currently emailed (if we have your email address) and also sent in paper form by mail. If you are happy to only receive email notification and **do not** need a paper letter please let SCIP know.

- South Island patients please email Helen/Debbie: reception@scip.co.nz
- North Island patients please email Sue: scip.wellington@scip.co.nz

Also a friendly reminder for our North Island patients to please contact our Lower Hutt Clinic on 0800 504 405 or scip.wellington@scip.co.nz for queries regarding appointments, equipment and spare parts etc.



SCIP patient Phillip Milne has recently returned from the Gold Coast of Australia where he took part in the Commonwealth Championships playing Rugby League. He was chosen out of a possible 30 athletes which was a huge honour! Phillip has had his cochlear implant for around 12 years. He was recently interviewed in the SCIP clinic by Audiologist Shirley Marshall and was proud to share his achievements with us and you, our patients.

Thank you and congratulations Phil!

What is the team you play for? PDRLNZ Team – stands for physical disability rugby league NZ team. Phil is a 'Black Short'. This is the first time I have been selected for this team. There is 1 other player from Christchurch; all the other players are from the North Island.

Who is in the team?

9 people on the field, 5 reserves. 20 people in total – including coaches, managers, physios

etc. They also have a woman. They have 2 people on the team who are allowed to be able-bodied, 7 players with physical disabilities.

When was the event? The Commonwealth championships - it was held Feb 21st –Feb 25th. Gold Coast, QLD, Australia.

What happened?

3 teams were competing for the cup. We ended up winning the silver medal. Australia PDRL team won gold and the Commonwealth All Stars team won bronze.

They play 9 minutes each way, with a 5 minute break in the middle, then another 9 minutes then we finish.

Do you wear your processor when you play? No, I take it off. It was raining all the time. 25 degrees, so it was warm! I like to tackle people during the game. I watch their lips carefully to see what they want to tell me. They will point to where they are going to put the ball.

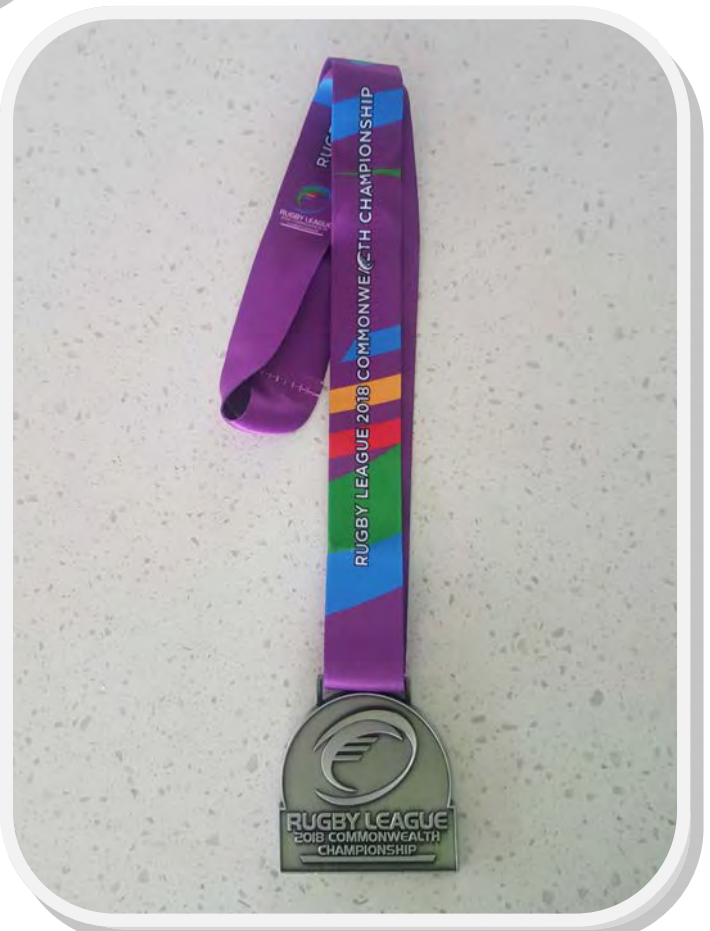



Is there anyone else on the team who wears a cochlear implant or who is deaf?

No, I am the only deaf player on the team. I didn't see anyone else who was deaf in over 300 people at the games.

What disabilities do the other players have?

Some people wear prosthetic legs. Some people have arms which don't work properly, or only 1 eye.

What are you planning to do next?

In September we are going to Sydney, NSW for another competition – the World 9s PDRL competition – will be playing teams from all over the world.

Where do you train?

I train at the Hornby Rugby League club. I also play Masters Rugby league. I started playing rugby when I was 15 years old. I am going to start training at the gym too.





Loud Shirt Day 2017



Well; both teams at SCIP have had a bit of fun on Loud Shirt Day on September 29th. Half the Christchurch team were in theatre doing some implant testing - **Naomi, Alex (our guest from MED-EL), Sarah, and Mel.**



Meantime Megan, Joanne, Shirley, Neil and Jill embarrassed themselves in Milford Chambers.



In Lower Hutt; Sue, Linda, Lisa, Helen and Joseph committed the necessary fashion crimes...while Hatten bravely took the photo!

This year LSD raised \$27,612 for the SCIP, to help deaf kids speak and hear, woohoo!

Thanks to all those who took part and supported the cause.



SCIP to offer Oticon Medical Cochlear Implant system

The SCIP would like to advise that it now offers the Oticon Medical Cochlear Implant system. This system is **available for private patients**; for funded patients the SCIP continues to use Cochlear Limited as its majority supplier.

The Oticon Medical system is based on the Neurelec system. Neurelec SA is (was) a French company that was acquired by Oticon Medical's parent company (William Demant) in 2013. Neurelec had more than 30 years of experience offering cochlear implant systems, mostly in European countries.

Information about the Oticon Medical cochlear implant system can be found on their web-site here;

<https://www.oticonmedical.com/cochlear-implants/new-to-cochlear-implants/what-is-a-cochlear-implant>

The Oticon Medical system is supported from within New Zealand, based at the Oticon NZ office in Wellington. Patients who may be considering funding their own cochlear implant are welcome to contact the SCIP Christchurch clinic for more details.

Queries can be addressed to: reception@scip.co.nz or by phoning 0800 500 405, SMS 027 355 3041.





Cochlear® Nucleus® 7 Sound Processor



Cochlear launched their new speech processor mid last year—the N7. It signified the beginning of an exciting new chapter for cochlear implant technology with its straight to iPhone streaming ability. This is technology that has been available for hearing aid users for some time, but cochlear implant users have always had to rely on an intermediary device to stream audio to their processors.

While the N7 has definitely made things easier for iPhone users to stream audio and mobile phone calls — never fear — there are other technological solutions for non N7 users to help achieve the same effect.

For Cochlear N6 users there is the Bluetooth Phone Clip, Mini Mic and TV Streamer which can provide direct audio streaming to your processor from your mobile phone, tablet, computer, home stereo or TV.

For Medel users the recommended device is the Artone Bluetooth Neckloop—available for purchase online.

For Advanced Bionics users the ComPilot or Roger Pen works well.

Some devices (such as Roger or the Artone Neckloop) will work with all cochlear implant processors so **there are definitely audio streaming options available to everyone, not just N7 users!**

Funding is often available for assisted listening devices whether you need them for work, study or for your general communication needs.

If you would like to discuss your listening needs or what assisted listening device might work well for your situation please talk to Linda, Penny or Nikki and we will do our best to help. Check out our contact details on the last page of this newsletter.

**CAPTIONED
MOVIES
NEW ZEALAND**

Did you know?

You can follow **Captioned Movies NZ** on Facebook for up to date information about which cinemas are screening recent movies with captions near you!



Adult User Support Groups

In some SCIP regional centres our adult patients have set up consumer support groups. These groups are administered and run by adult patients themselves.

The groups are an opportunity to meet other adult recipients, share experiences, learn from one another, and provide each other support.

Below we list the contact details for those individuals that co-ordinate the group in your area. If there is no-one available in your area then you might consider starting a group; contact the programme here and we may be able to help facilitate this.

NEW PLYMOUTH:

Allison Tijssen/Sue Clare

Email: j.a.tijssen@hotmail.com
sue.clare@vodafone.co.nz

PALMERSTON NORTH:

Chris Sinclair

Email: csinclair15@vanasch.school.nz

WELLINGTON:

Pauline Brown

Email: nick.pauline@xtra.co.nz

NELSON:

Bill Clarkson

Email: william.clarkson66@gmail.com

Pam Fraser

Email: teddybear_851@hotmail.com

BLenheim:

Tania Shearer

Email: tancias@lifeunlimited.net.nz

CHRISTCHURCH:

Graham Williams

Email: jan.graham@slingshot.co.nz

SOUTH CANTERBURY

Lynley Simmons

Email: lyn.muzz@ihug.co.nz

DUNEDIN:

Genny Hanning/Fiona Ali

Email: gennyhann@gmail.com
fiona6914@gmail.com

INVERCARGILL:

Roy and Marj Bremer

Email: mrbremer@kinect.co.nz



The Southern Cochlear Implant Programme Facebook Group



For those that don't know, we have a Facebook group for patients and families. The Facebook page is a "closed" group and can be found at:
<http://www.facebook.com/groups/scip.paed/>

Recipients and families from the Southern region may apply to join; this is then approved by an Administrator at the SCIP.

We encourage people to join the Facebook page. It is an opportunity for the programme to keep people informed about changes and happenings that may interest or affect our patients and their families. It is also an opportunity for recipients to connect with others in a similar situation. Many patients have told us that they have found the page valuable.

The SCIP Public Facebook Page

We have also (separately) launched a Facebook page. This page is open and is used by the programme to raise awareness and provide information to the wider community about the SCIP and cochlear implants in general. The page can be found here:
<https://www.facebook.com/southernCochlearImplantProgramme>

Web-Site

(www.scip.co.nz)

The web-site has recently been revised. The revision should provide easier navigation and access for patients, professionals, or the general public to be able to find information.

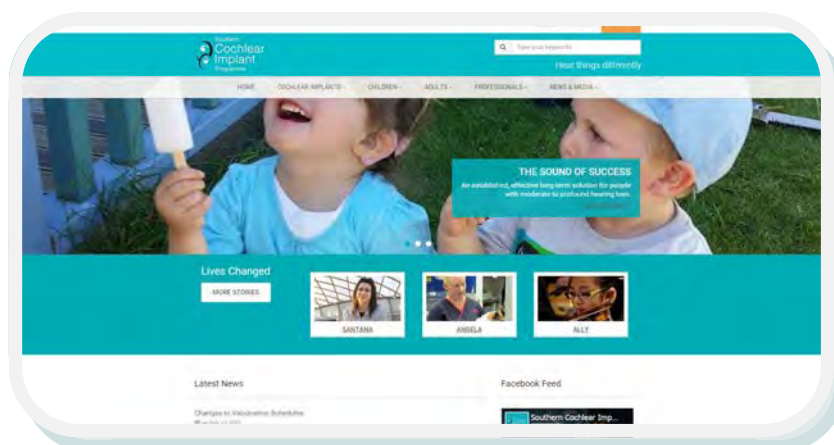

Wi-Fi in the Rooms

We have Free Wi-Fi access for patients in our rooms for those waiting for appointments. On arrival ask at reception for password details.



Troubleshooting

If you experience problems with your device, we advise you to contact the SCIP in the first instance. Alternatively, Cochlear Limited, MED-EL and Advanced Bionics all have “troubleshooting” information on their web-sites that may help.

The range of information available can include:

- If your processor stops working
- Replacing microphone protectors
- Connecting to a wireless device
- Using your remote control
- Changing battery packs
- Connecting an FM system

Material is often available in both printed and/or video form.

Cochlear Limited

<http://www.cochlear.com/wps/wcm/connect/au/home/support/how-to-guides>



MED-EL

<http://www.medel.com/troubleshooting/>



Advanced Bionics

<https://www.advancedbionics.com/content/advancedbionics/nz/en/home/support/troubleshooting-guide.html>



Spare parts charges

While a significant portion of patient costs are provided for by the Ministry of Health, patients (particularly adults), are expected to fund some items themselves and these costs need to be borne in mind. Current pricing and warranty information is available on our web-site or by emailing tui.brewster@scip.co.nz

At the time of assessment and prior to surgery these costs are discussed with patients. For those on limited incomes, WINZ may be able to provide assistance. For children, these costs are provided for until the 19th birthday is reached, after which people become “adults” under the terms of the Ministry of Health service specification and must self-fund these costs as well.



Private Funding

Individuals who do not wish to wait on a public waiting list for either an assessment or, after assessment, a cochlear implant procedure are able to fund the assessment and/or implant procedures themselves.

Our Finance Administrator Tui Brewster (tui.brewster@scip.co.nz) can be contacted for the costs of private assessments and implant procedures.

Paying for Parts and Accessories

Do you find that you struggle to pay for replacement parts when you need them? We have a solution for you. You can set up a weekly / fortnightly / monthly automatic payment and we will hold the funds until you need to make a purchase. Details are as follows:

Account No.	02-0800-0611344-000
Account Name	SCIP Adult Programme
Reference	your name

Contact tui.brewster@scip.co.nz if you need further information.

MRI Procedures

If at any time you are referred for an MRI scan you should, in all cases, consult the programme before undergoing any MRI procedure. We can provide advice to your Radiology provider.

As a general rule if you as a recipient are undergoing any medical procedure then please contact the programme at the earliest opportunity for the relevant advice.



Do you have a medical ID? In the event of an accident a Medic Alert bracelet can help alert medical professionals to your hearing loss and your CI. Find out more at www.medicalert.co.nz



Hearing Henry Headbands

Hearing Henry headbands have been popular with many families. They help retain speech processors on small and not-so-small ears, in every day use and in sporting or other activities. They are now also making Adult size headbands for use in sporting activities.

Here is the website if you wish to find out more or make a purchase:

<https://www.hearinghenry.com/>

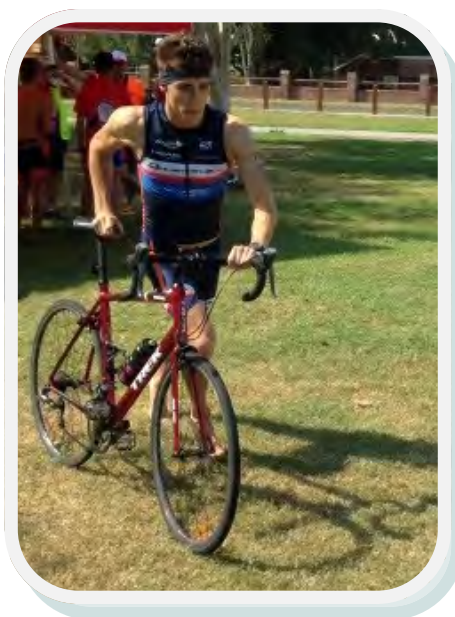
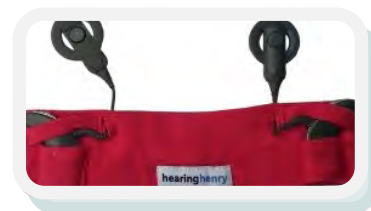

Helpful hints and reminders:

A reminder to everyone about the necessity of a deaf smoke alarm – this is an important piece of safety equipment for all of you to have in your homes. As well as beeping loudly like a traditional smoke alarm they can be connected to strobe lights and bed shakers in order to alert the deaf person sleeping. They are often fully funded and information on these is available through your local fire service or hearing therapist.



Do you know about the Text 111 service? If you're not confident talking on the phone you can register your name and number with the Text 111 service so that in an emergency you can text 111 instead of having to call.

If you have any questions about any of the above items or about anything rehabilitation related please get in contact with us: linda.hatten@scip.co.nz or penny.monteath@scip.co.nz or nikki.cleine@scip.co.nz

**General Manager**

Neil Heslop

neil.heslop@scip.co.nz

Clinical Manager

Jill Mustard

jill.mustard@scip.co.nz

Administration—Clinical

Gillian Nicolle

gillian.nicolle@scip.co.nz

Helen Landrebe

reception@scip.co.nz

Debbie Swanson

reception@scip.co.nz

Sue Anderson*

SCIP.Wellington@scip.co.nz

Administration—Finance

Tui Brewster

tui.brewster@scip.co.nz

Audiologists

Naomi Gibson

naomi.gibson@scip.co.nz

Shirley Marshall

shirley.marshall@scip.co.nz

Hatten Howard*

hatten.howard@scip.co.nz

Joseph Dalrymple*

joseph.dalrymple@scip.co.nz

Sarah Weusten

sarah.weusten@scip.co.nz

Gemma McCombie

gemma.mccombie@scip.co.nz

Adult Rehabilitationists

Penny Monteath

penny.monteath@scip.co.nz

Nikki Cleine

nikki.cleine@scip.co.nz

Linda Hatten*

linda.hatten@scip.co.nz

Paediatric Habilitationists

Joanne Lake

jlake69@vanasch.school.nz

Megan Chinnery

mchinnery25@vanasch.school.nz

Lisa Fawcett*

lfawcett154@vanasch.school.nz

Karen Watson*

kwatson15@vanasch.school.nz (on maternity leave)

Helen Hawkins*

hhawkins50@vanasch.school.nz

Surgeons (Contact via Administration Staff)

Phil Bird

Rebecca Garland*

Melanie Souter

Alice Stringer*

* denotes Wellington service

**SOUTHERN COCHLEAR IMPLANT PROGRAMME—ADDRESS DETAILS****Milford Chambers Rooms**

Southern Cochlear Implant Programme
Block 1 Milford Chambers
St. George's Hospital
249 Papanui Road
Christchurch 8014

Phone 03 355 3041
FAX 03 355 3045
Freephone 0800 500 405
Mobile 027 355 3041
Email reception@scip.co.nz

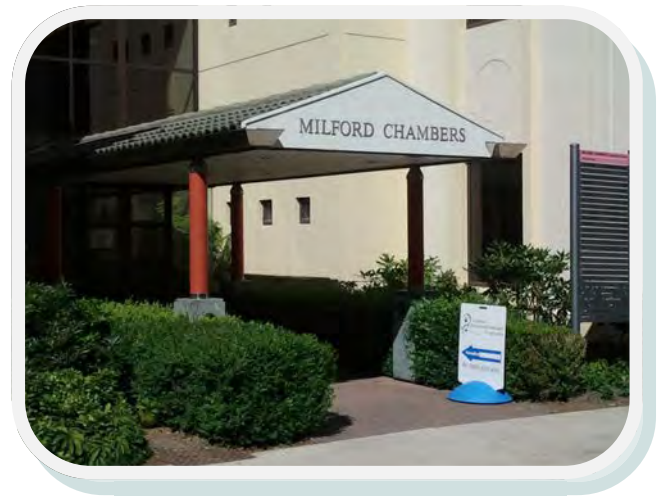
**Wellington Service**

Southern Cochlear Implant Programme
Level 1, JAG Legal Building
119 Queens Drive
Lower Hutt 5010

Phone 04 5899 853
FAX 04 5899 854
Freephone 0800 504 405
Mobile 027 589 9853
Email SCIP.Wellington@scip.co.nz

